

# INSTALLATION GUIDE FOR ALL SIMPLY STAINLESS PRODUCTS WITH GLASS RINSER

## SBM-GR + SBM-GR-VA



WMTS.101  
WM-040293  
SIMPLY STAINLESS  
Model number: SBM-GR + SBM-GR-VA

**SIMPLY  
STAINLESS**  
Modular Bar Solutions

### SBM-GR

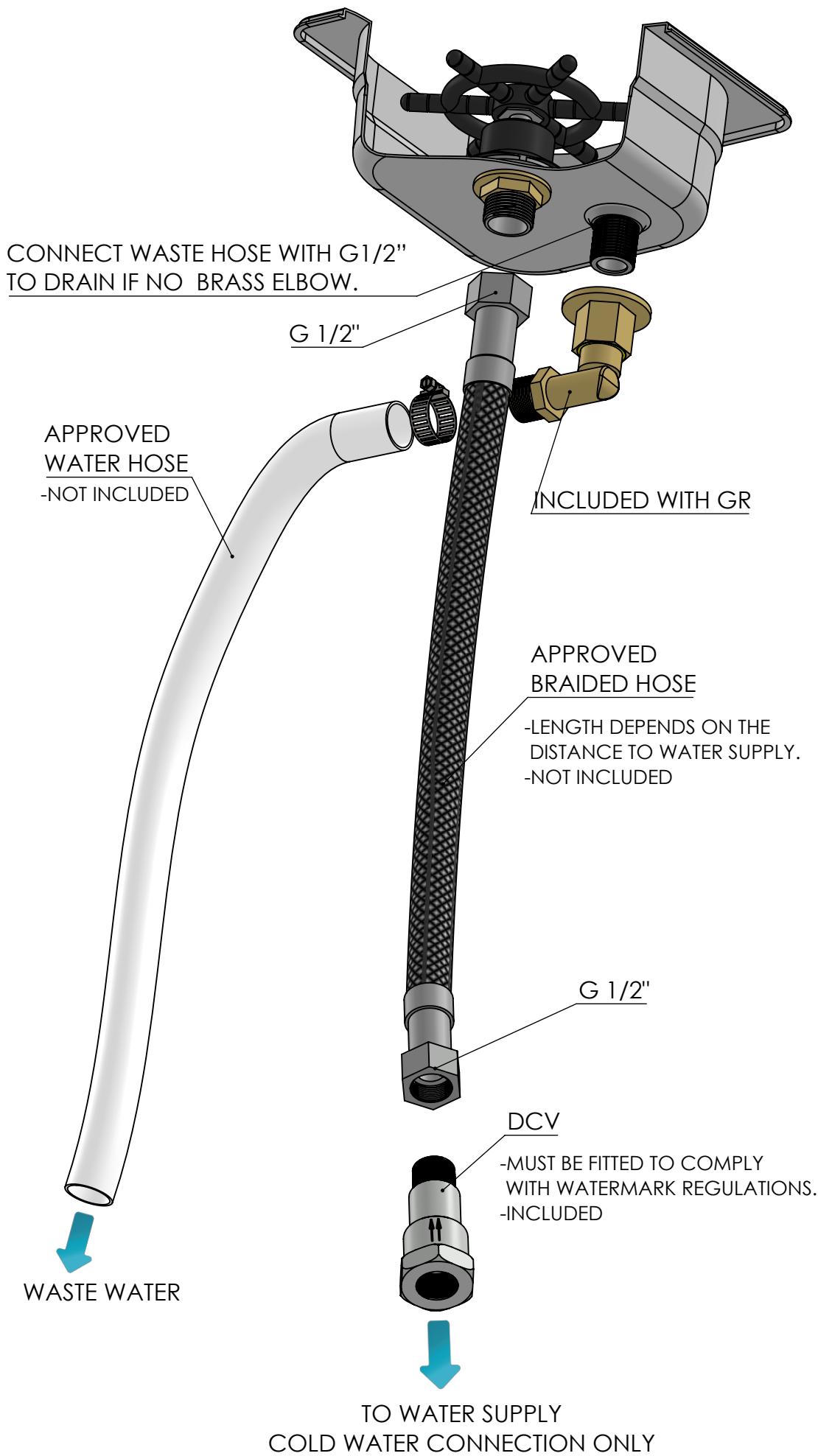

#### SPECIFICATIONS:

|                                   |   |
|-----------------------------------|---|
| DRAIN CONNECTION:                 | G 1/2" TO TO WATER DRAIN.<br>WASTE HOLE Ø13mm MINIMUM.  |
| WATER CONNECTION:                 | G1/2" TO GLASS RINSE.   |
| DUAL CHECK VALVE:<br>(DCV)        | (MODEL ID. WF-DUC-01)<br>WATERMARK CERTIFICATE NO. WMK25739   |
| CONSTRUCTION &<br>WARRANTY NOTES: | FOR ALL SIMPLY STAINLESS PRODUCTS<br>WITH GLASS RINSER, REFER TO OUR WEBSITE.<br><a href="http://www.simplystainless.com">www.simplystainless.com</a> |

#### PLUMBING: (INSTALLATION AND COMMISSIONING BY LICENSED PLUMBER ONLY)

INSTALLATION IS SUBJECT TO THE REQUIREMENTS OF THE APPLICABLE REGULATORY AUTHORITY, THE NATIONAL CONSTRUCTION CODE VOLUME THREE - PLUMBING CODE OF AUSTRALIA, ASSOCIATED REFERENCE STANDARDS AS APPLICABLE AT THE TIME AND AS/NZS 3500.

ONLY QUALIFIED PLUMBER FOR INSTALLATION AND MAINTENANCE. TO INSTALL TIGHTEN EACH INLET CONNECTION TO 10-20 NM TORQUE. LEAKAGE TEST SHALL BE DONE BEFORE FIRST USE

MAX WATER SUPPLY TEMPERATURE: 5C TO 35C, COLD WATER ONLY.

MAKE SURE AN INDIVIDUAL 100KPA-500KPA PRESSURE LIMITING WITH BACKFLOW PREVENTION VALVE(DCV) MUST BE FITTED TO RINSER ONLY.

CONNECT RINSER WITH AN APPROVED BRAIDED HOSE TO THE DCV.

CONNECT DRAIN BARB WITH AN APPROVED HOSE AND CLAMP, GRADE HOSE TO YOUR DRAIN POINT MAKING SURE THERE IS A STEADY FALL DOWN AND THE END HOSE ISN'T SUBMERGED UNDER THE WATER LINE.

FOLLOW THE SIMPLE STEPS TO INSTALL THE GLASS RINSER AS PER THE ILLUSTRATION.

CLEAR WATER LINES BEFORE CONNECTING THE GLASS RINSER.

CHECK FUNCTION AND LEAKAGE TEST SHALL BE DONE BEFORE FIRST USE AND EVERY YEAR.

NO ADJUSTMENT REQUIRED ONCE ALL CHECKING COMPLETE.

TROUBLE SHOOTING GUIDE: ISOLATE AND CALL A LICENCED PLUMBER.

#### OPERATING INSTRUCTION

PRESS DOWN IN RINSER WITH GLASS/JUG FOR MINIMUM 5 SECONDS.

#### MAINTENANCE

CLEAN RINSER AFTER EACH DAY.

#### WARRANTY TERMS

SEE SIMPLY STAINLESS WEBSITE FOR DETAILS.

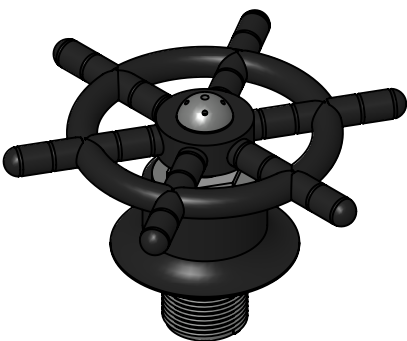

### SBM-GR-VA